

# 1041 Injector With EFC

## Installation

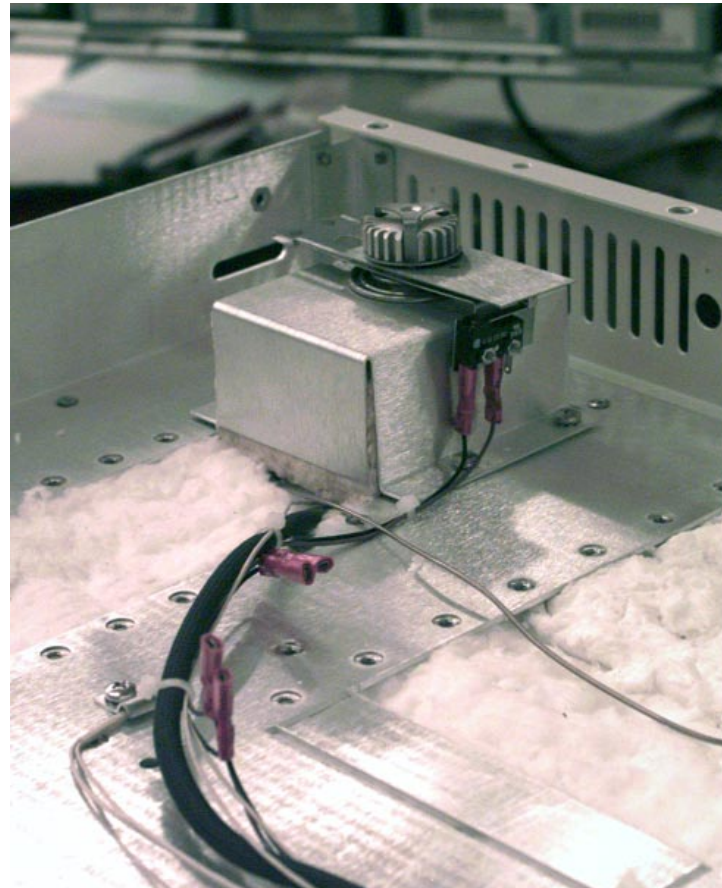

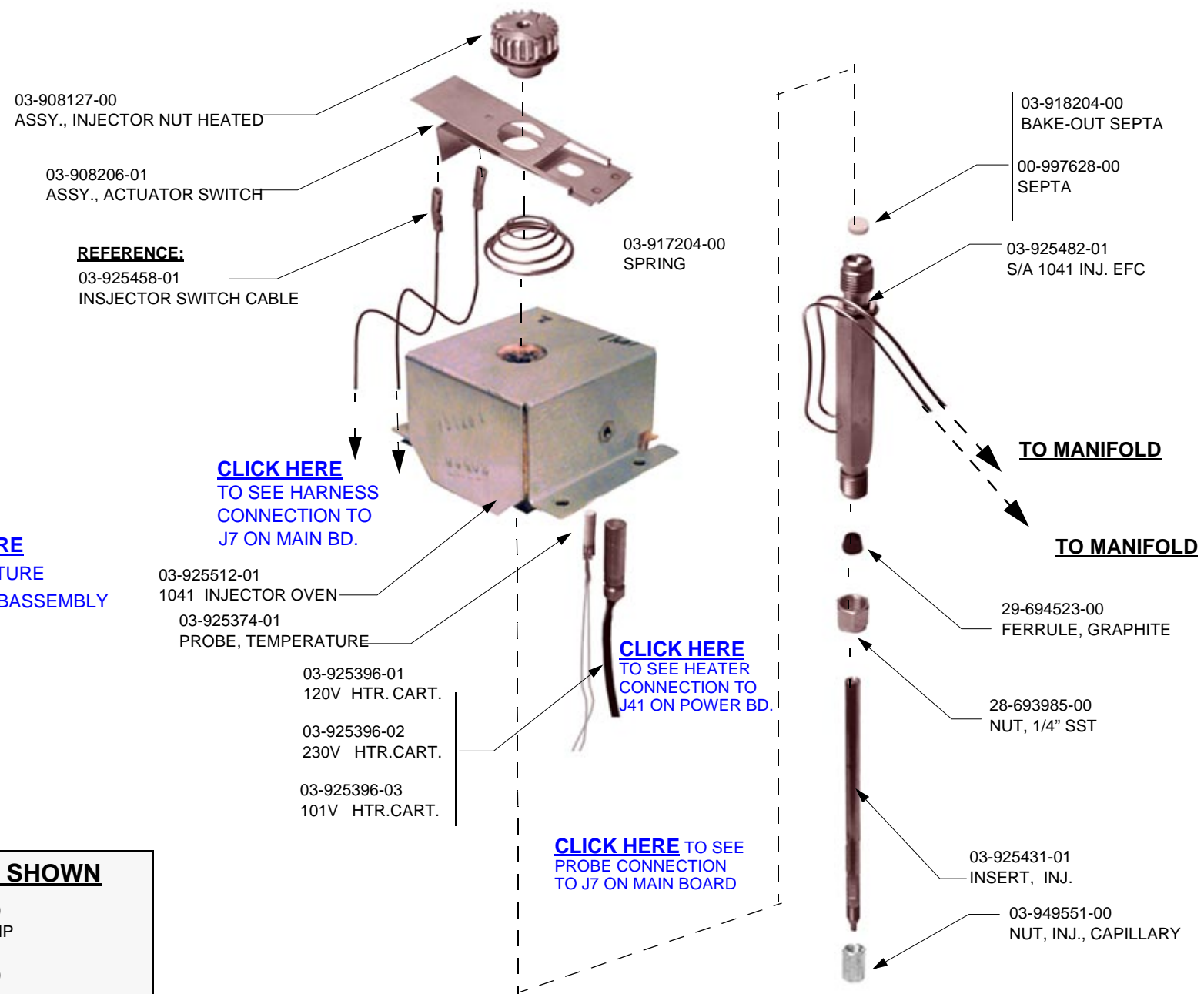

**PARTS NOT SHOWN**

- 22-012004-00  
CABLE CLAMP
- 12-901165-00  
SCREW

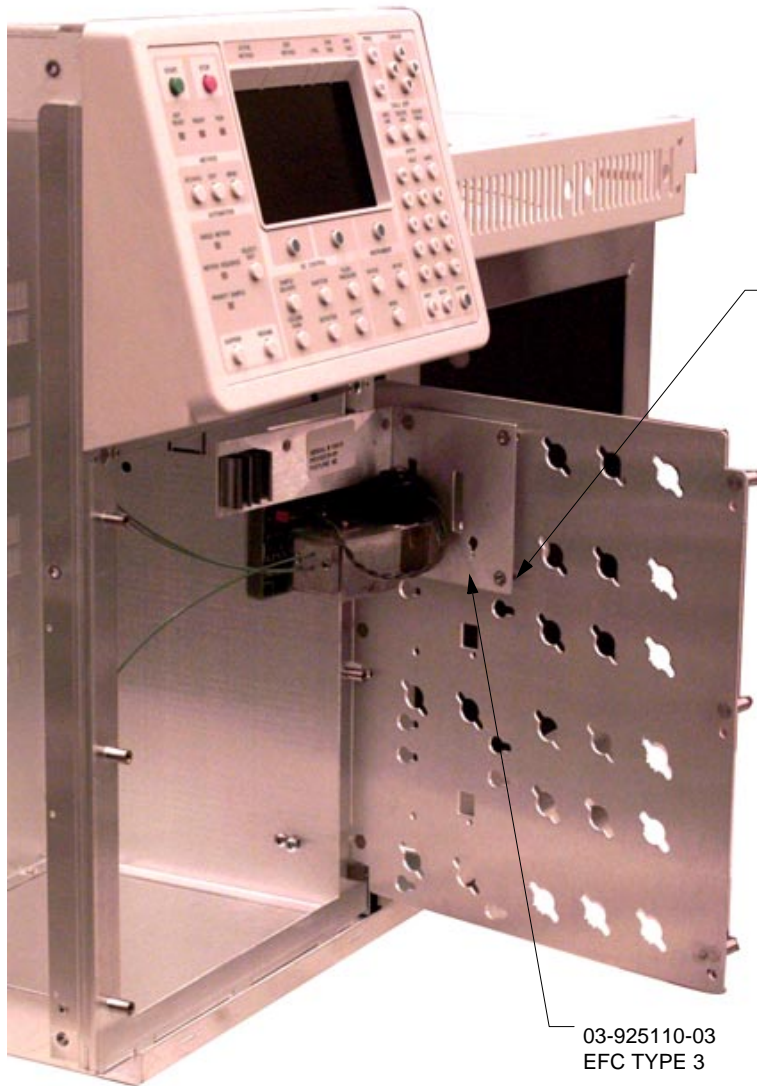

12-901163-00  
SCREW, 8-32 X 3/8"  
EXT. LW 4EA. 8 TOTAL

03-925374-01  
PROBE, TEMPERATURE

REFERENCE  
03-925458-01  
INJECTOR SWITCH CABLE

03-925396-01  
120V HTR. ION

03-925396-02  
220V HTR. ION

03-925396-03  
101V HTR. ION

03-925110-03  
EFC TYPE 3

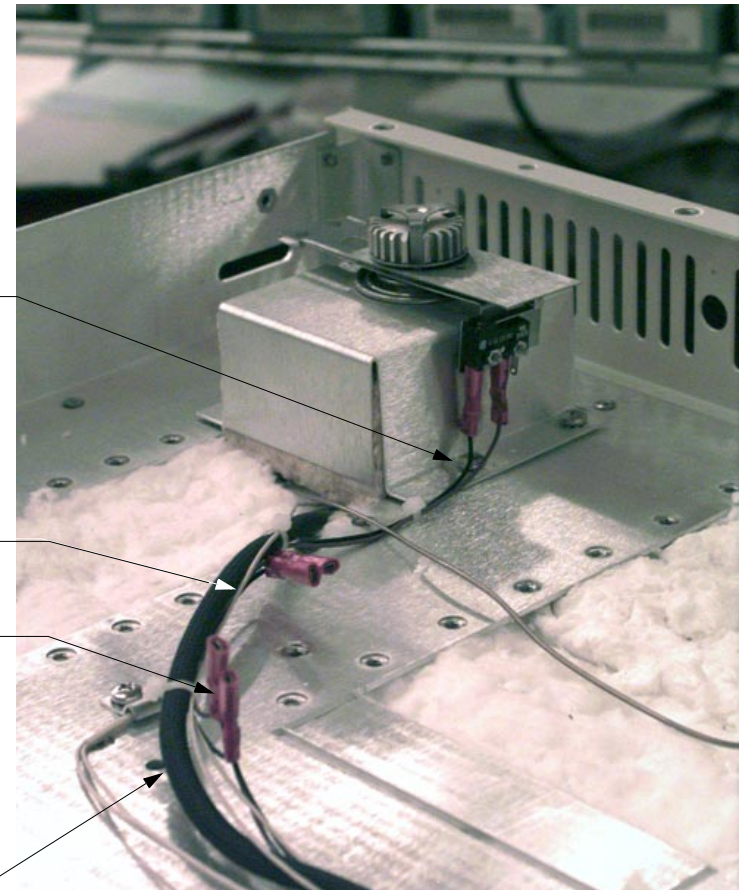

[CLICK HERE](#) TO SEE  
PROBE AND INJECTOR  
SWITCH CONNECTION  
TO J7 ON MAIN BOARD

[CLICK HERE](#) FOR  
HEATER CONNECTION  
TO J41 ON POWER BD.

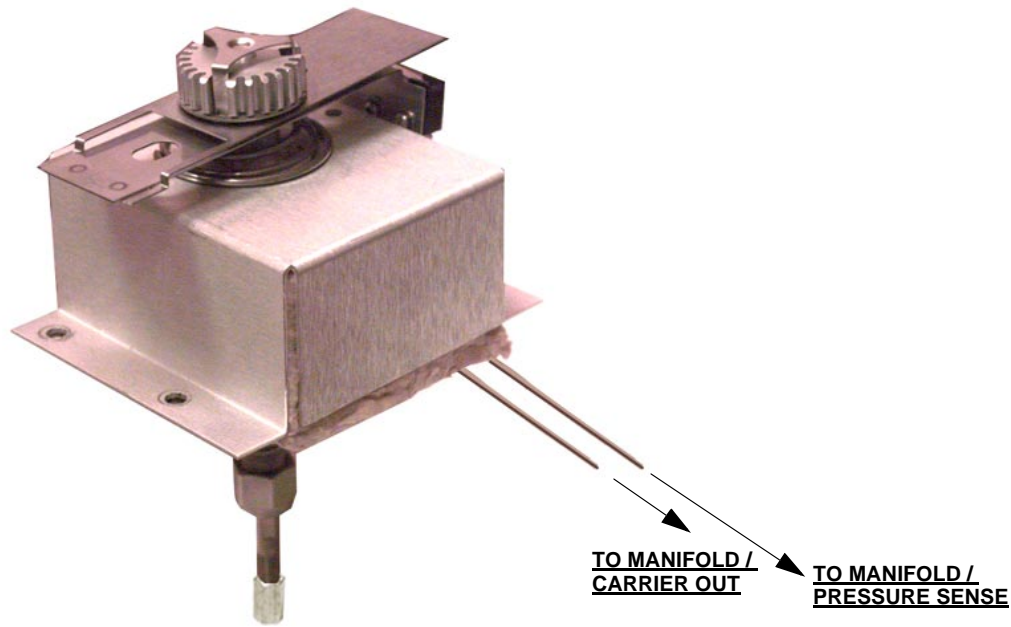

**1041 / EFC INJECTOR, 3800**

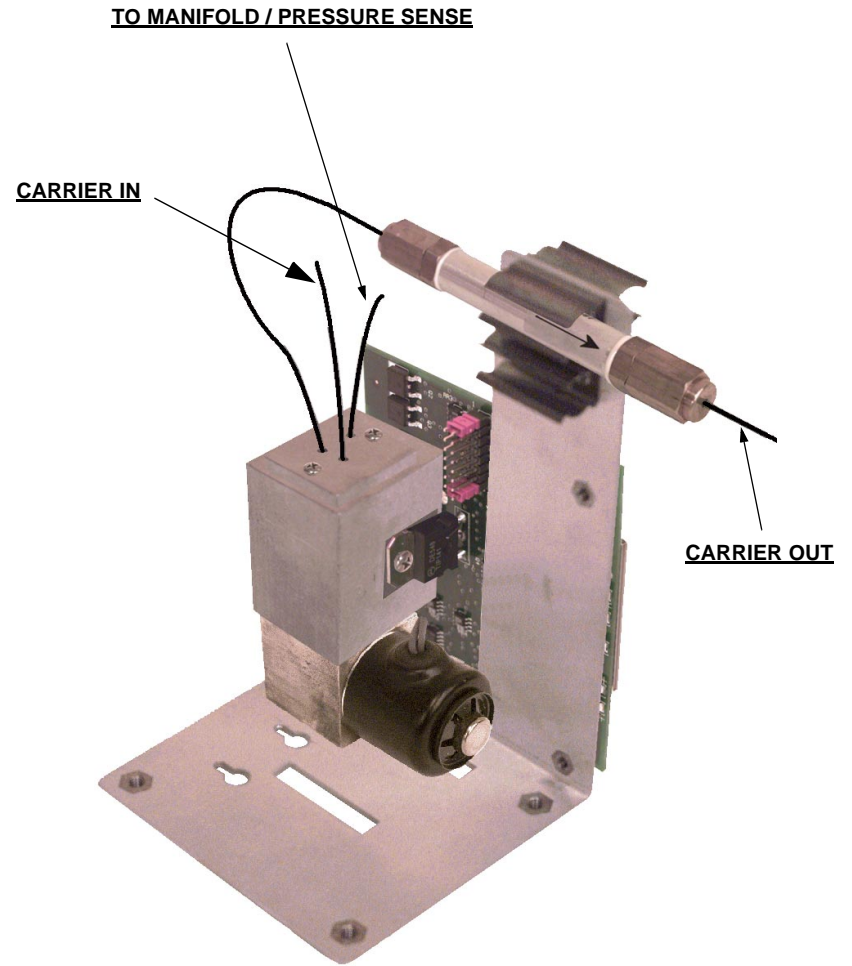

**TYPE 3 EFC, 3800**

